

TILLAMOOK COUNTY SURVEYORS OFFICE  
COURT HOUSE, TILLAMOOK OREGON 97141

SECTION CORNER COMMON SECTIONS  
2, 3, 10, & 11 T.1S., R.8W., W.M.

T1SRBW  
S 3| S 2  
----+----  
S10| S11  
1953  
2311

I found a 1 1/2" iron pipe with a 3" O.S.B.F. Bronze Cap, (see T.C.S. Rewitness Book 2 at Page 264). I encased the found iron pipe in a 10" concrete cylinder.

-----  
History of found monument

I found this monument to be as described in Tillamook County Surveyors Rewitness Book 2 at page 264 and the references found and/or set at that time to now be as follows:

(Original) 8" alder S.53 W. 36 lks., reported on above as 20" X 10' high stub, chopped out east of scribes; (Now gone).

(Book 4 Page 38) 14" spruce S.40 E. 42', reported on above rewitness as 16' stub with scribes CS BT at the same bearing and distance; (Now gone).

(Book 2 Page 264) \*24" cedar snag N.65 E. 96 ft.; (Found, now 18" snag, scribing visible on open face, N.60 E. 97.74' to the face. This bearing tree is now located on the NE side of a recent slide and is leaning Northerly.

(Book 2 Page 264) \*18" alder N.51 1/2 W. 51.5 ft.; (Now 28" alder with healed face? N.52 W. 55.5').

(Book 2 Page 264) \*8" alder S.31 E. 57 ft.; (Now 28" alder with stretched scribing visible S.31 E. 62.4'). The slide material from the slide Southwesterly of the NE BT has come down between the corner and this BT.

(Book 2 Page 264) \*78" fir stump S.29 30'W. 176 ft.; (Found, now a 78" fir stump 8' high on the down hill side, scribing visible, S.29 30'W 170.08' to an aluminum nail in the center of the top of the stump.

-----  
New Accessory

\*72" light hat section post North 1.5'.

\*indicates Tillamook County Surveyors yellow metal location poster attached.

-----  
Surveys and Rewitnesses of record

A-379		W.E. Anderson	PE 1697
Rewitness Book 2 Page 264	3-11-53	Louis M. Amort	PE 2311
Rewitness Book 4 Page 38	4-07-32	W.E. Anderson	CS
Field notebook 69 page 1-4 & 102-104	4-07-32	W.E. Anderson	CS

-----  
Monument Location

This monument is located approximately 300' NE of an old logging road and approximately 75' NE of a small creek.

-----  
In the presence of Dan McNutt and Al Dvorak

August 12, 1991

Title:

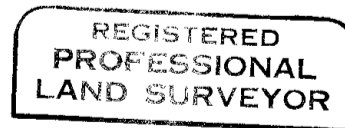

*Allan E. Duncan, C.S.*

